

QUICK REFERENCE GUIDE: Apply for License or ID

1 Click Apply for License or ID workflow.

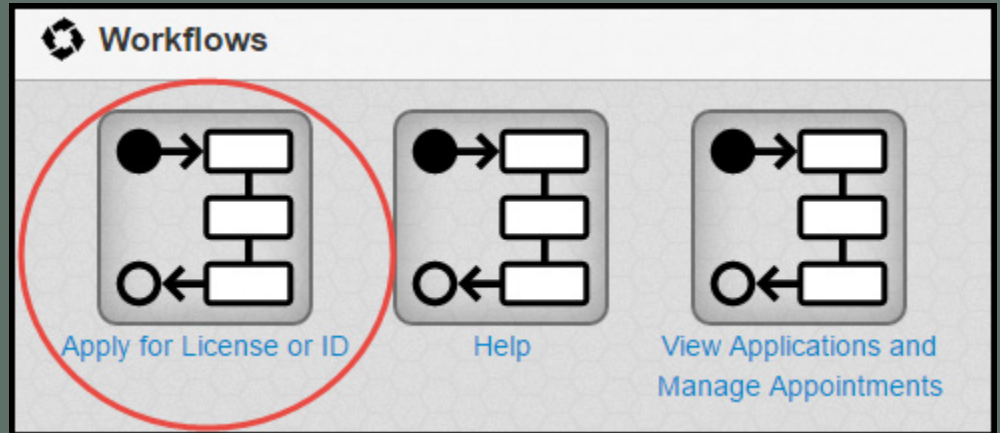

The screenshot shows the application form with three sections highlighted in red boxes: '1. Enter your personal information', '2. Select your Citizenship status', and '3. Select your desired Credential'. The 'Submit Application' button is also circled in red.

2 Complete all three sections of the Apply for License or ID form, including the pop-up windows, and then click Submit Application.

VALID